

# M42 Junction 6 Development Consent Order

**Scheme Number TR010027**

## **8.31 Indicative Proposal for Main Compound and Office for M42 J6 Scheme**

Planning Act 2008

Rule 8(1)(k)

The Infrastructure Planning (Examination  
Procedure) Rules 2010

Volume 8

July 2019

Infrastructure Planning

Planning Act 2008

The Infrastructure Planning  
(Examination Procedure) Rules 2010

**M42 Junction 6**

Development Consent Order 202[ ]

---

**Indicative Proposal for Main Compound  
and Office for M42 J6 Scheme**

---

<b>Regulation Number</b>	Rule 8(1)(k)
<b>Planning Inspectorate Scheme Reference</b>	TR010027
<b>Document Reference</b>	8.31
<b>Author</b>	M42 Junction 6 Development Consent Order Team and Highways England

<b>Version</b>	<b>Date</b>	<b>Status of Version</b>
1	1 July 2019	Final

Indicative proposals for main compound and offices for M42 J6 Improvement Scheme

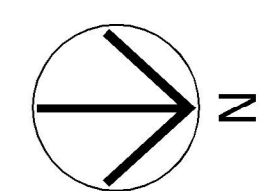
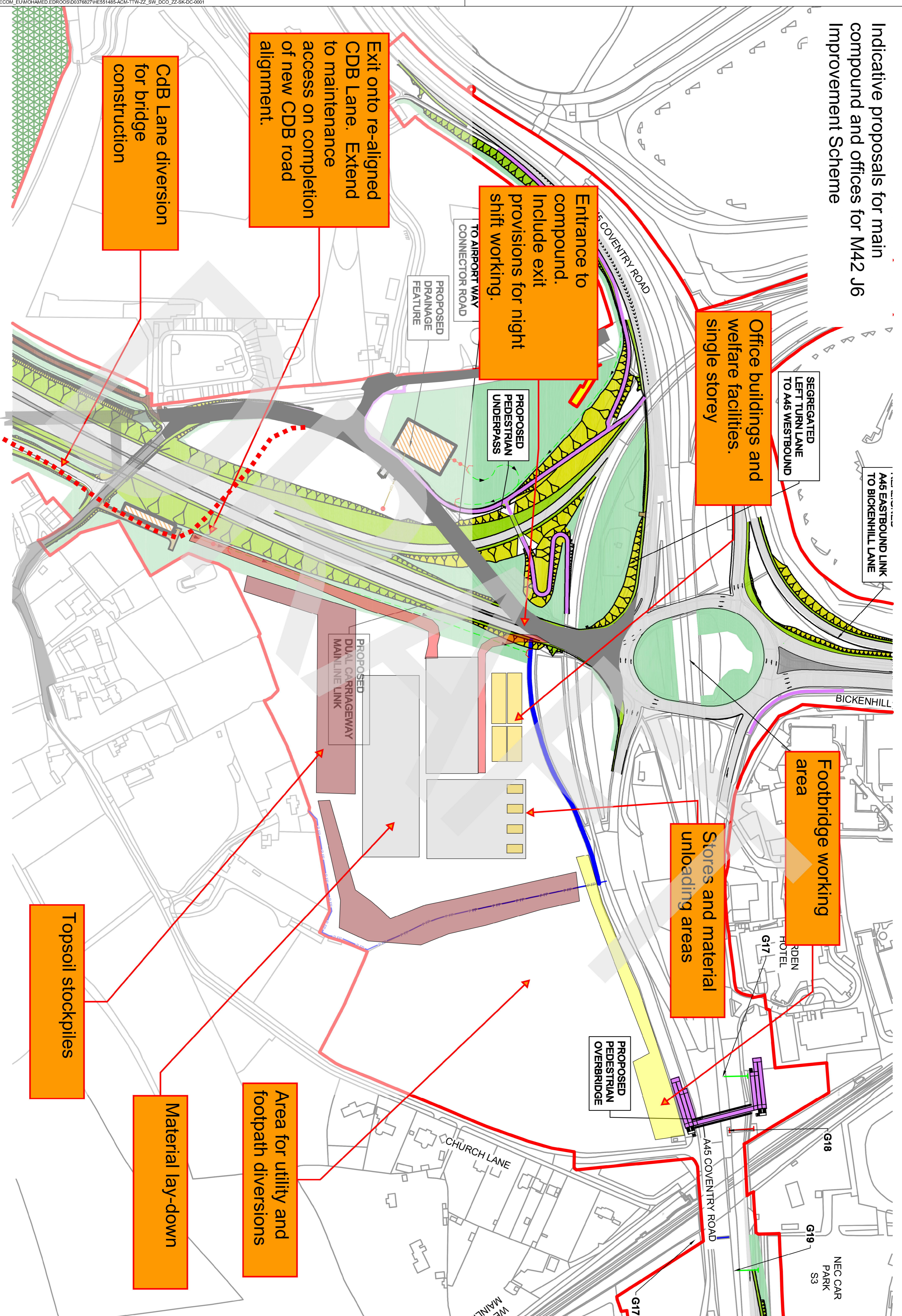

- NOTES
1. THIS DRAWING IS TO BE READ IN CONJUNCTION WITH ALL OTHER RELEVANT DOCUMENTATION.
  2. DO NOT SCALE FROM THIS DRAWING. USE ONLY PRINTED DIMENSIONS.
  3. ALL DIMENSIONS IN METRES. ALL CHANGES, LEVELS AND COORDINATES ARE IN METRES UNLESS DEFINED OTHERWISE.

First Issue	02/07/19	PO1.1
Revision Details	By	Date
Purpose of Issue	Check	Slack

**FOR INFORMATION**

Client: Highways England  
Floor 5, Queens Square  
38 Colmore Circus  
B4 6BN

Development Consent Order Number: TR010027

Project Title: M42 JUNCTION 6 IMPROVEMENT

Drawn: TMS

**INDICATIVE PROPOSAL FOR MAIN COMPOUND AND OFFICES FOR M42 J6 SCHEME**

Designed	Drawn	Checked	Approved	Date
M/S	M/S	M/S	J/P	30/05/2019
Referential Project No:	60543032	Stability	SZ	
Scale @ A1		Zone	Scheme Wide General	

THIS DOCUMENT HAS BEEN PREPARED PURSUANT TO A CONTRACT FOR THE DESIGN AND CONSTRUCTION OF A HIGHWAY AND THE DRAWING IS NOT TO BE USED FOR ANY OTHER PURPOSE WITHOUT THE WRITTEN PERMISSION OF HIGHWAYS ENGLAND. THE DRAWING IS THE PROPERTY OF HIGHWAYS ENGLAND AND IS NOT TO BE REPRODUCED OR TRANSMITTED IN ANY FORM OR BY ANY MEANS, ELECTRONIC OR MECHANICAL, INCLUDING PHOTOCOPYING, RECORDING, OR BY ANY INFORMATION STORAGE AND RETRIEVAL SYSTEM. THE USER OF THIS DOCUMENT ACCEPTS AND AGREES TO INDEMNIFY AND HOLD HIGHWAYS ENGLAND HARMLESS FROM AND AGAINST ALL CLAIMS, DAMAGES, LOSSES AND EXPENSES, INCLUDING REASONABLE ATTORNEY'S FEES, ARISING OUT OF OR IN CONNECTION WITH THE USE OF THIS DOCUMENT.

Drawn by: HE551485 - ACM  
Checked by: TTW - SK-DC-0001  
Location: ZZ\_SW\_DCO\_ZZ  
1 Type 1 Role 1 Number

1 Volume - P01.1  
1 Title - TTW - SK-DC-0001  
1 Date - 30/05/2019